

Farmer Automatic

# Combi System

Combi Layer System

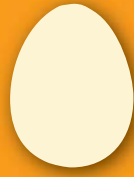

# The intelligent combi layer system



## Flexibility comes as standard

The Farmer Automatic Combi System is a logical step forward in aviaries which takes the risk out of deciding which system to invest in. With just a few moves the patented system transforms into enriched cages, setting new standards in future-oriented versatility and investment security for poultry farming.

## Integrated equipment

- All decks are fully equipped to the same standard (feed, nest boxes, perches, lighting, water, plastic coated floor mesh).

## Safe feeding and drinking

- The light is centrally positioned for even lighting distribution throughout the system.
- The drinking lines are also centrally positioned below the light, ensuring the birds have access to water.
- A tried-and-tested Farmer Automatic feed chain ensures good food intake and reduced feed loss.

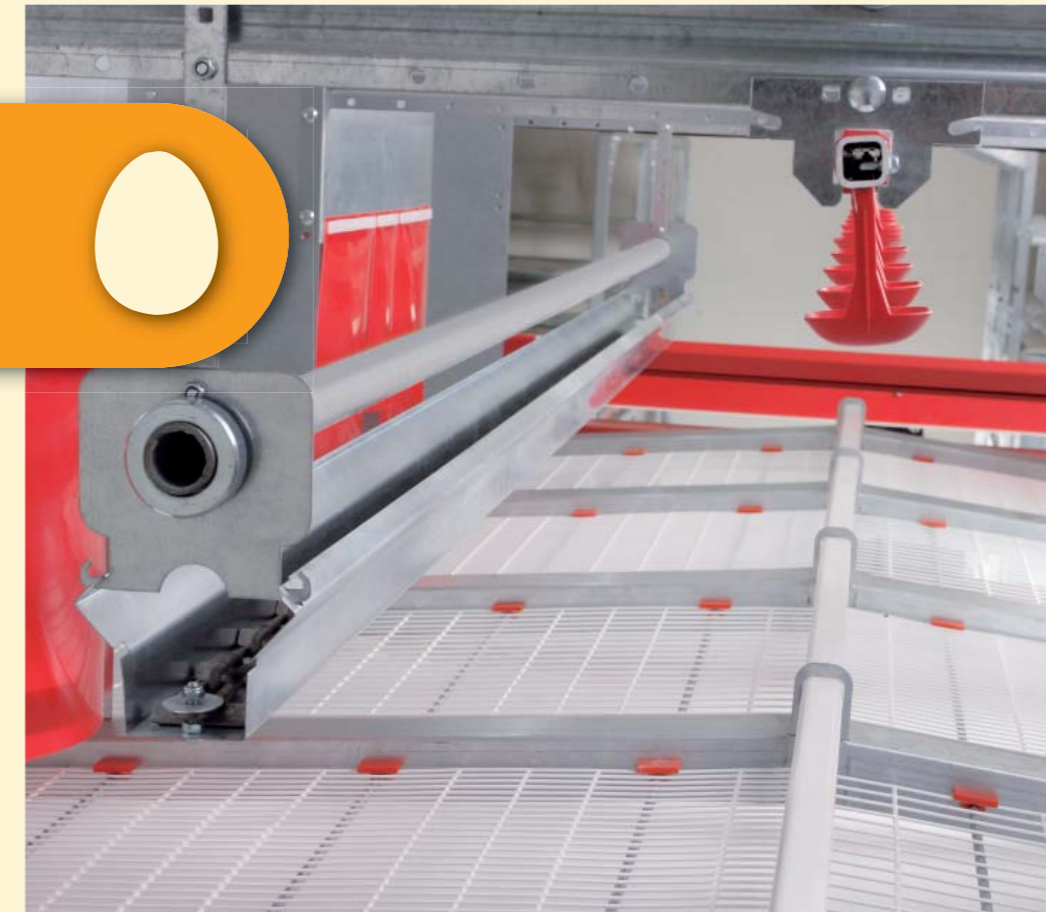

## High-quality materials

- Plastic-coated floor mesh provides a high degree of self-cleaning: manure does not stick and mites cannot become established.

## Intelligent details

- Eggs are automatically collected and transported on egg collection belts.
- Farmer Automatic perches are specifically designed for poultry and made of various materials such as 1 inch metal pipes, 28 x 28 mm PVC pipes and metal profiles, allowing each hen to choose its own roosting place.
- The Farmer Automatic manure removal system reduces ammonia build-up and fly infestations to provide a cleaner house environment.
- In situations where the law permits, the Farmer Automatic Combi System can be converted into enriched cages in just a few moves.



Safe and hygienic: the Farmer Automatic manure removal



Finding feed and water more quickly: 24V LED light tubes aid orientation



Reliable and careful: automatic egg collection

## Advantages at a glance

- Flexible, easily converted and therefore easily upgradeable system
- Each tier equipped with nesting boxes, feed, water, perches and light
- Plastic-coated floor mesh
- Eggs roll from the nest straight onto the egg collection belt
- 24V LED light tubes ensure that birds can easily find feed and water
- The high number of perches provides hens with a good choice of roosting spaces



Farmer Automatic

# Combi System

Combi Layer System

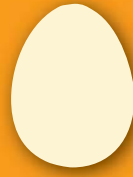

## Specifications

Section length	2,400 mm
System height	Two and three tiers
Manure belt width	from 1,750 to 1,995 mm
Deck height	760 mm

The Combi System can optionally be equipped with overhead drying. The integrated system solution for efficient manure drying permanently improves the pen's climate and simultaneously reduces operating costs.

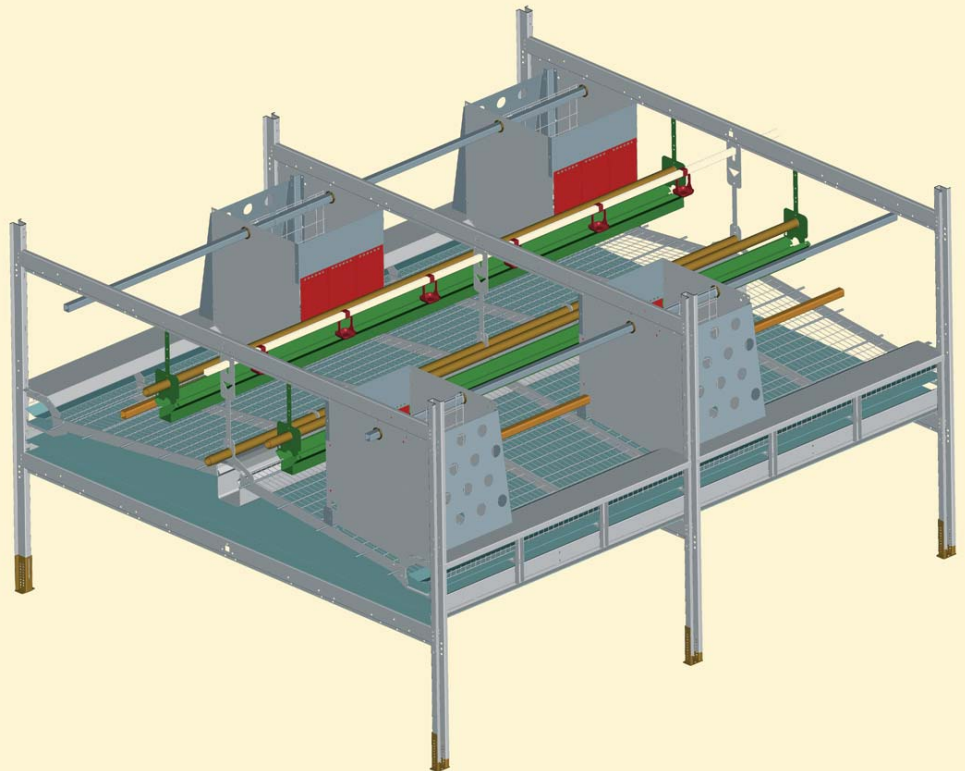

## German-made success

Farmer Automatic offers innovative products for ultramodern poultry farming. With more than 45 years of experience in the market worldwide, we produce and sell complete solutions from a single source with a range of products designed to be always flexible and adapt to poultry farmers' individual requirements.

As a personally managed family company we work as partners to our customers, always on hand to provide effective support for their long-term success. Together we work towards real growth so that we are always one step ahead of the demands of the market.



Farmer Automatic • Josef Kühlmann GmbH & Co. KG

Königstraße 51 • 48366 Laer • Germany • Phone: +49 (0) 25 54 - 911 - 0 • Fax: +49 (0) 25 54 - 911 - 66 • [www.farmerautomatic.de](http://www.farmerautomatic.de)